

EXPERIENCE

The technical primer
Technical data for the competence catalogue



2 Inspiring details!

All of EXPRESSO's products have been manufactured from our modular system for more than four decades – for example, over 2000 different hand trucks are available from stock. Of course, we can't list all of them here, otherwise the Technical Primer would be more extensive than the competence catalogue. Similarly, the range of order-picking carts and loading aids meets every customer need, thanks to our modular system philosophy. The "In Focus" appears next to the product description in the catalog, and shows the most important technical details at a glance. In addition to the products pictured, the following pages list numerous versions, e.g. different sizes, heights & widths, loading platform dimensions, load capacities, plus the associated prices.

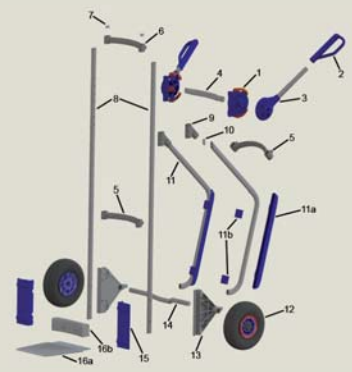
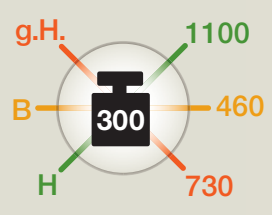

EXPRESSO's original spare parts service

All our products undergo exacting quality tests. However, should a worn part have to be replaced, you simply make use of our original spare parts service. Should you have any questions about products or specific features – simply ask us. We look forward to hearing from you.





Manual transport equipment & accessories page 4 ff



Loading aids & accessories page 10 ff



Order-picking carts & accessories page 16 ff

We look forward
to hearing from you.



EXPRESSO Deutschland GmbH
Tel.: + 49 (0) 561 95 91-0
Fax: + 49 (0) 561 95 91-198
E-Mail: info@expresso.de

All text and image rights of the competence catalogue and the technical primer are reserved exclusively for EXPRESSO Deutschland GmbH. Technical details are subject to change in the interest of constant product improvement.



Manual transport equipment & accessories



Hand trucks

Page	Type	Load capacity kg	Weight kg	Axle width mm	Overall width mm	Height mm	Footplate L x W mm	Wheel Ø mm
24	283 811 21	300	11.3	440	560	1,300	245 x 220	260
24	284 811 21	300	11.5	440	560	1,400	245 x 220	260
25	285 811 21	300	11.7	440	560	1,500	245 x 220	260
25	285 815 25	300	13.4	440	560	1,500	300 x 305	260
26	2 011 25	300	11.2	440	560	1,300	245 x 220	260
26	2 015 21	300	11.4	440	560	1,300	300 x 305	260
26	2 011 23 150	300	10.9	440	560	1,500	245 x 220	260
27	2 011 21	300	10.1	440	560	1,300	245 x 220	260
27	2 015 25	300	12.0	440	560	1,300	300 x 305	260
28	213 815 21	200	10.6	440	500	1,300	300 x 305	260
28	233 811 21	250	11.3	440	500	1,300	245 x 220	260
28	243 815 21	300	12.4	440	500	1,300	300 x 305	260
29	243 811 21	300	11.7	440	500	1,300	245 x 220	260
29	243 815 25	300	13.0	440	500	1,300	300 x 305	260

Stacking hand trucks

Page	Type	Load capacity kg	Weight kg	Axle width mm	Overall width mm	Height mm	Footplate L x W mm	Wheel Ø mm
30	2 031 21	300	10.0	440	590	1,300	245 x 220	260
30	2 055 21	300	10.6	440	500	1,500	300 x 305	260
30	2 071 66	300	11.6	440	500	1,700	245 x 220	260
31	5 204 66	300	16.2	440	500	1,300	90 x 380	260
31	2 071 66 02+121002	300	17.6	440	590	2,500	245 x 220	260

Folding hand trucks

Page	Type	Load capacity kg	Weight kg	Axle width mm	Overall width mm	Height mm	Folded height mm	Footplate L x W mm	Wheel Ø mm
34	261 851 42	150	11.9	405	420	1,100	730	245 x 220	200
34	261 851 21	150	11.9	440	460	1,100	730	245 x 220	260
34	271 851 21	150	12.8	440	460	1,100	730	245 x 220	260
35	271 851 23+1194	150	12.8	440	460	1,100	730	245 x 220	260
35	2 851 42	150	8.9	405	420	1,100	670	245 x 220	200
36	251 291 74	100	8.8	405	405	1,100	730	245 x 220	200
36	251 276 74	100	7.0	405	405	1,100	730	425 x 220	200
36	851 278 74	100	8.4	475	475	1,100	730	520 x 280	200
37	251 280 74	125	9.0	475	475	1,100	730	425 x 280	200
37	0 226 00	80	5.1	—	500	1,070	750	320 x 420	180

Vehicle hand trucks

Page	Type	Load capacity kg	Weight kg	Axle width mm	Overall width mm	Height mm	Footplate L x W mm	Wheel Ø mm
38	2 821 21	200	8.3	440	460	1,150	245 x 220	260
38	2 821 21+1199	200	8.8	440	460	1,150	245 x 220	260
38	231 825 25	250	10.4	440	460	1,100	300 x 305	260
39	231 821 21	250	10.0	440	460	1,100	245 x 220	260
39	211 821 21	200	9.0	440	460	1,100	245 x 220	260

Mail & parcel hand trucks

Page	Type	Load capacity kg	Weight kg	Axle width mm	Overall width mm	Height mm	Folded height mm	Footplate L x W mm	Wheel Ø mm
42	823 280 42	125	12.0	530	535	1,300	—	430 x 350	200
42	821 270 42	150	10.2	475	475	1,100	—	425 x 280	200
43	823 271 42	150	10.6	475	475	1,300	—	425 x 280	200
43	823 271 42G	150	10.6	475	475	1,300	—	425 x 280	200
44	201 277 74	100	8.1	405	405	1,100	—	425 x 220	200
44	2 011 21G	300	10.1	440	560	1,300	—	245 x 220	260
44	2 018 21G+1190	300	13.1	440	560	1,300	—	400 x 350	260
45	821 274 74	75	6.9	475	475	1,100	—	200 x 285	200
45	851 276 7402	150	9.5	475	475	1,120	710	425 x 280	200

Parcel & service hand trucks

Page	Type	Load capacity kg	Weight kg	Axle width mm	Overall width mm	Height mm	Footplate L x W mm	Wheel Ø mm
46	881 270 4201G+1312+1340	150	12.5	475	500	1,100	600 x 500	200
46	883 270 4201G+1340	150	10.7	475	500	1,300	600 x 500	200
47	881 270 42G	150	10.2	475	475	1,100	425 x 280	200
47	883 270 42G	150	10.6	475	475	1,300	425 x 280	200

Beverage & dual stacking trucks

Page	Type	Load capacity kg	Weight kg	Axle width mm	Overall width mm	Height mm	Footplate L x W mm	Wheel Ø mm
50	2 212 21	200	11.2	440	560	1,300	180 x 190	260
50	2 232 21	200	10.6	440	590	1,300	180 x 190	260
50	2 252 21	200	11.2	440	500	1,500	180 x 190	260
51	243 212 21	200	12.1	440	500	1,300	180 x 190	260
51	285 212 21	200	11.9	440	560	1,500	180 x 190	260
52	243 212 21+1046	200	12.8	440	500	1,300	180 x 190	260
52	843 215 24	200	15.6	510	575	1,300	200 x 200	260
52	5 200 24	250	16.0	440	500	1,600	—	260
53	8 018 24	300	13.5	510	515	1,300	200 x 500	260
53	843 818 24+1220	300	15.6	510	575	1,300	200 x 500	260
54	2 015 25+1228	300/30	21.5	440	560	1,300	300 x 305	260
54	2 036 21+119702	300	10.0	440	590	1,300	180 x 340	260
54	243 8110 25+1222+1052	300	15.8	440	500	1,300	230 x 430	260

SB-Wagen

Page	Type	Load capacity kg	Weight kg	Overall width mm	Height mm	Length mm	Load area L x W mm	Wheel Ø mm
55	0 498 71	200	25.3	650	1,000	1,270	930 x 450	175
55	0 488 71	200	25.0	650	1,000	1,170	830 x 450	175
55	0 494 71 (without brake)	200	24.8	650	1,000	1,270	930 x 450	175
55	0 484 71 (without brake)	200	24.5	650	1,000	1,170	830 x 450	175
55	0 498 71ER	200	27.3	650	1,000	1,270	930 x 450	175
55	0 488 71ER	200	26.8	650	1,000	1,170	830 x 450	175
55	0 494 71ER (without brake)	200	26.8	650	1,000	1,270	930 x 450	175
55	0 484 71ER (without brake)	200	26.3	650	1,000	1,170	830 x 450	175

Deep-freeze & convenience trucks

Page	Type	Load capacity kg	Weight kg	Axle width mm	Overall width mm	Height mm	Footplate L x W mm	Wheel Ø mm
58	221 277 42	100	11.0	405	410	1,100	400 x 350	200
58	5 230 42	150	12.0	405	405	1,300	400 x 350	200
58	2 711 21GK	200	9.2	440	460	1,300	245 x 220	260
59	823 280 2103	200	11.5	560	575	1,300	600 x 350	260
59	823 280 4203	125	12	470	475	1,300	400 x 350	200
60	2 017 21+1190	300	12.5	440	560	1,300	400 x 350	260
60	848 810 24GV	300	14.5	510	575	1,300	200 x 500/520 x 200	260

Combination pallet lifter

Page	Type	Load capacity kg	Weight kg	Fork length mm	Overall length mm	Overall width mm	Height mm	Lifting height mm	Wheel Ø mm
61	04 675	500	67.6	700	1,100	740	1,050	400	—

Multi-purpose trucks

Page	Type	Load capacity kg	Weight kg	Axle width mm	Overall width mm	Height mm	Folded height mm	Footplate L x W mm	Wheel Ø mm	
64	631 636 21	300	14.5	600	665	1,120	—	120 x 510	260	
64	634 636 21	300	15.5	600	665	1,400	—	120 x 510	260	
64	631 645 76	300	13.0	470	475	1,120	—	110 x 400	200	
65	822 820 21	150/300	11.5	510	585	1,200	—	540 x 280/180 x 340	260	
65	831 820 21	150/300	9.0	510	575	1,130	—	540 x 280/180 x 340	260	
66	843 820 21	150/300	15.0	510	575	1,300	—	540 x 280/180 x 340	260	
66	8 015 25 1500*	150/300	15.0	510	585	1,500	1,300	300 x 305	260	
66	823 820 21 160KL*	150/300	14.0	510	575	1,600	1,200	540 x 280/180 x 340	260	
67	833 820 25 17001	150/300	14.0	510	575	1,700	—	540 x 280/180 x 340	260	
67	833 820 25 17001+1213	150/300	23.0	510	575	1,700	—	540 x 280/180 x 340	260	
67	833 820 21 17001+1213	150/300	20.5	510	575	1,700	—	540 x 280/180 x 340	260	
66	* 300 kg load capacity only when used with folded upright and rigid footplate									

Dual-purpose hand trucks

Page	Type	Load capacity kg	Weight kg	Axle width mm	Overall width mm	Height mm	Folded height mm	Footplate L x W mm	Load area L x W mm	Wheel Ø mm
68	5 536 21	300	16.3	440	540	1,350	1,030	180 x 340	900 x 280	260/125
68	5 536 25	300	16.3	440	540	1,350	1,030	180 x 340	900 x 280	260/125

Electric stair climbers

Page	Type	Load capacity kg	Weight kg	Axle width mm	Overall width mm	Height mm	Footplate L x W mm	Wheel Ø mm
69	8 051 96	140	31.2	460	510	1,500	245 x 220	260
69	8 044 96 S+11970201	140	29.8	460	560	1,400	400 x 500	260

Chair transport trucks

Page	Type	Load capacity kg	Weight kg	Axle width mm	Overall width mm	Height mm	Folded height mm	Footplate L x W mm	Wheel Ø mm
72	2 011 21+1144	300/80	12.1	440	560	1,300	—	245 x 220	260
72	243 811 21+1044	300/80	14.7	440	500	1,300	—	245 x 220	260
73	243 811 23+1029+1196	300	14.3	440	600	1,300	—	245 x 220	260
73	710 01+104403	200/80	12.2	440	460	1,250	—	245 x 220	260

Baggage trolleys

Page	Type	Load capacity kg	Weight kg	Axle width mm	Overall width mm	Height mm	Load area L x W mm	Wheel Ø mm
74	910 632 42H	500	35.5	1,130	730	1,000	950 x 700	200
74	910 699 42H	500	43.5	1,030	730	1,860	1000 x 700	200
75	8 932 10 (chrome-plated steel)	100	14.5	720	525	950	440 x 400	125/150
75	8 927 571	200	16.5	905	640	990	670 x 550	175

Baggage trucks

Page	Type	Load capacity kg	Weight kg	Axle width mm	Overall width mm	Height mm	Footplate L x W mm	Wheel Ø mm
76	821 272 42	150	9.5	475	475	1,100	425 x 280	200
76	821 278 42	150	10.5	475	475	1,100	425 x 280	200
76	823 276 42H	150	9.5	475	475	1,300	425 x 280	200
77	843 262 23	200	12.5	510	575	1,300	600 x 280	260
77	843 263 23	200	13.0	510	575	1,300	600 x 280	260

Tyre trucks

Page	Type	Load capacity kg	Weight kg	Axle width mm	Overall width mm	Height mm	Footplate L x W mm	Wheel Ø mm
80	543 810 25	200	17.0	510	530	1,300	—	260
80	546 810 25	200	19.0	510	530	1,650	—	260
80	546 810 2501	200	25.0	510	530	1,650	—	260
81	243 814 21	300	15.7	440	500	1,300	400 x 500	260
81	211 824 21	200	13.4	440	500	1,100	400 x 500	260

Drum-handling trucks

Page	Type	Load capacity kg	Weight kg	Axle width mm	Overall width mm	Height mm	Footplate spacing mm	Footplate L x W mm	Wheel Ø mm
84	3 301 21 (Steel, hot-dip galv.)	450	17.0	620	760	1,530	280	—	260
84	3 309 21 (Stainless steel)	450	18.0	620	760	1,530	245	—	260
84	3 307 66 (Steel, hot-dip galv.)	500	20.2	620	760	1,530	315	—	260
85	823 138 24	250	16.0	510	520	1,200	—	200 x 500	260

Steel hand trucks

Page	Type	Load capacity kg	Weight kg	Axle width mm	Overall width mm	Height mm	Footplate L x W mm	Wheel Ø mm
88	6 636 21 (Steel, hot-dip galv.)	300	13.0	460	635	1,080	120 x 400	260
88	6 726 21 (Steel, hot-dip galv.)	350	17.0	600	635	1,120	100 x 510	260
88	7 163 66 (Steel, hot-dip galv.)	350	24.2	480	595	1,300	350x 390	260
89	2 106 21 (Steel, hot-dip galv.)	250	15.5	460	460	1,300	245 x 220	260
89	2 109 21 (Stainless steel)	250	15.5	460	515	1,300	245 x 220	260

Accessories for hand trucks and self-service trolleys

Page	Type	Description	for axle widths
92	108004	Advertising panel, printed on one side	440
92	1080G	Advertising panel, printed on one side, for straight cross-members	440
92	108208	Advertising panel, printed on one side	510
92	1082G	Advertising panel, printed on one side, for straight cross-members	510
92	1083	Advertising panel, printed on one side	530
92	1190	Central strut for hand trucks, with profiled safety handle	—
92	1191	Central strut for folding hand truck Type 2 851 42	—
92	1194	Central strut for folding hand trucks	—
92	1196	Central strut for hand trucks with dog-ear handles and CLICK4	—
92	1093/1193	Upright extension for folding / standard hand trucks	405, 440/440
93	1044	Chair loading frame, 520 x 340 mm (height-adjustable)	440
93	1050	Table loading frame (can only be used together with chair loading frame type 1044)	440
93	104403	Chair loading frame, 400 x 240 mm (height-adjustable)	440
93	1144	Chair loading frame, 510 x 285 mm	440
93	1029	Chair loading attachment, 600 mm	440
94	1311	Load area widener, W x H: 500 x 1.150 mm, for hand trucks of 1,300 mm or more	440
94	1312	Load area widener, W x H: 500 x 750 mm, for hand trucks of 1,100 mm or more	440
94	131001	Load area widener for type 5 230 42, W x H: 440 x 1,100 mm	405
94	119702	Load area widener, W x H: 480 x 1,000 mm, for hand trucks of 1,300 mm or more	—
95	1222	Folding side retainer bracket	—
95	1052	Folding safety catch	—
95	1166	Aluminium stowing hanger	—
95	1023/1225	Crate bracket	440/510
95	1220	Side retainer bracket, foldable, 3-stage adjustment (410, 550, 610 mm)	all
95	1046	Retainer catch	—
95	087	Coin unit for self-service trolleys and baggage carts	—
95	1088	Folding safety bracket for self-service trolleys	—
96	1228	Water bottle carrier	—
96	0 1318	Small pallet, L x W: 335 x 485 mm	—
96	117301/02	Tilting aids	440/510
96	1104	Drum grapple	—
96	304 3 033	Protective profiles, grey	—
96	1037	Retainer for rolls and steel cylinders	440
96	301 3 037/301 3 038	Soft protectors 70 mm/140 mm	—
97	1179	Tipping aid and safety belt	—
97	1172/1176/1178	Carrying frames	440/600/510
97	0 155 250/350	Ratchet straps 2,500/3,500 mm	—
97	0 155 1500/2500/3500	ClipFix ratchet strap 1,500/2,500/3,500 mm	—
98	1210	Supporting wheel for hand trucks of 1,400 mm or more	440
98	1211	Supporting wheels for multi-purpose truck	600
98	1213	Supporting wheels for transport allrounder hand trucks	510
98	1270	Supporting wheel for drum truck	—
98	1455	Side retainer bracket	530
99	301 3 034	Safety reflectors	—
99	1002	Rain cover	—
99	01012	Delivery bag for mail & printed matter, L x W x H: 240 x 420 x 300 mm	—
99	090	Wire basket, W x H: 465 x 265 mm (inside dimensions)	—

Accessories for manual transport equipment

Page	Type	Description	for axle widths
100	1500	Mobile lifting unit, lifting range up to 1,150 mm, capacity 100 kg	440
100	1501	Mobile lifting unit, lifting range up to 750 mm, capacity 100 kg	440
100	150013	Stabilizer feet, foldable	—
100	150011	Stabilizer feet, rigid version	—
100	00K128	Leather working gloves	—
100	1171	Fork extensions for combination pallet lifter (Extension to 910 mm)	—

Accessories for electric stair climbers

Page	Type	Description	for axle widths
101	1313	Load area widener, L x W x H: 100 x 500 x 900 mm	—
101	1116	Sliding skid set	—
101	901 9 346/901 9 347	Battery charger for use in vehicles, 12 V / 24 V	—
101	901 9 345	Mains-operated charger, 100-240 V	—
101	901 9 344	Battery pack	—



Loading aids & accessories



Foldable loading ramps

Page	Type	Load capacity kg	Weight kg	Length mm	Overall width mm	max. height difference mm	Handles
106	8 772 20	400	32	2,000	800	600	2
106	8 772 26	240	40	2,600	800	750	2
106	8 772 44	300	2 x 16	2,000	2 x 400	600	4

Telescoping loading rails

Page	Type	Load capacity kg	Weight kg	Length mm	Overall width mm	max. height-difference mm	Track width mm (per unit)	Handles
107	8720002	300	12,7	1,100-2,000	218	400	190	2
107	8728503	260	18,3	1,100-2,850	200	600	170	2

Heavy-duty loading rails

Page	Type	Load capacity kg/Pair	Weight kg/Piece	Length mm	Overall width mm	Height mm	Track width mm
108	873021/120 (w/o ill.)	900	6	1,200	210	35	210
108	873021/150 (w/o ill.)	700	8	1,500	210	35	210
108	873021/180 (w/o ill.)	500	9	1,800	210	35	210
108	873021/210 (w/o ill.)	400	11	2,100	210	35	210
108	873021/240	200	12	2,400	210	35	210
108	873029/120 (w/o ill.)	1.200	6	1,200	290	35	290
108	873029/150 (w/o ill.)	900	7	1,500	290	35	290
108	873029/180 (w/o ill.)	700	8	1,800	290	35	290
108	873029/210 (w/o ill.)	500	9	2,100	290	35	290
108	873029/240 (w/o ill.)	300	10	2,400	290	35	290
108	873041/120 (w/o ill.)	1.400	12	1,200	410	35	410
108	873041/150 (w/o ill.)	1.100	14	1,500	410	35	410
108	873041/180 (w/o ill.)	900	16	1,800	410	35	410
108	873041/210 (w/o ill.)	700	19	2,100	410	35	410
108	873041/240 (w/o ill.)	500	21	2,400	410	35	410
108	873041/270 (w/o ill.)	300	24	2,700	410	35	410
108	873049/120 (w/o ill.)	1.600	14	1,200	490	35	490
108	873049/150 (w/o ill.)	1.300	17	1,500	490	35	490
108	873049/180 (w/o ill.)	1.000	19	1,800	490	35	490
108	873049/210 (w/o ill.)	800	22	2,100	490	35	490
108	873049/240 (w/o ill.)	600	25	2,400	490	35	490
108	873049/270 (w/o ill.)	300	28	2,700	490	35	490
108	873061/120 (w/o ill.)	2.000	17	1,200	610	35	610
108	873061/150 (w/o ill.)	1.600	20	1,500	610	35	610
108	873061/180 (w/o ill.)	1.300	24	1,800	610	35	610
108	873061/210 (w/o ill.)	1.000	27	2,100	610	35	610
108	873061/240 (w/o ill.)	700	31	2,400	610	35	610
108	873061/270 (w/o ill.)	400	34	2,700	610	35	610
108	874021/120 (w/o ill.)	1.800	7	1,200	210	45	210
108	874021/150 (w/o ill.)	1.600	9	1,500	210	45	210
108	874021/180 (w/o ill.)	1.300	10	1,800	210	45	210
108	874021/210 (w/o ill.)	900	12	2,100	210	45	210
108	874021/240 (w/o ill.)	800	14	2,400	210	45	210
108	874021/270 (w/o ill.)	500	15	2,700	210	45	210
108	874021/300 (w/o ill.)	300	17	3,000	210	45	210
108	8740255/120 (w/o ill.)	2.100	7	1,200	255	45	255
108	8740255/150 (w/o ill.)	1.900	9	1,500	255	45	255
108	8740255/180 (w/o ill.)	1.500	10	1,800	255	45	255
108	8740255/210 (w/o ill.)	1.000	12	2,100	255	45	255
108	8740255/240 (w/o ill.)	900	14	2,400	255	45	255
108	8740255/270 (w/o ill.)	600	15	2,700	255	45	255
108	8740255/300 (w/o ill.)	350	17	3,000	255	45	255
108	874032/120 (w/o ill.)	2.700	10	1,200	320	45	320
108	874032/150 (w/o ill.)	2.400	12	1,500	320	45	320
108	874032/180 (w/o ill.)	1.900	14	1,800	320	45	320
108	874032/210 (w/o ill.)	1.300	16	2,100	320	45	320
108	874032/240 (w/o ill.)	1.200	18	2,400	320	45	320
108	874032/270 (w/o ill.)	1.000	20	2,700	320	45	320
108	874032/300 (w/o ill.)	800	22	3,000	320	45	320
108	874041/120 (w/o ill.)	3.000	13	1,200	410	45	410
108	874041/150 (w/o ill.)	2.800	16	1,500	410	45	410
108	874041/180 (w/o ill.)	2.400	19	1,800	410	45	410
108	874041/210 (w/o ill.)	1.800	22	2,100	410	45	410
108	874041/240 (w/o ill.)	1.600	25	2,400	410	45	410
108	874041/270 (w/o ill.)	1.300	28	2,700	410	45	410
108	874041/300 (w/o ill.)	1.000	32	3,000	410	45	410

Lightweight loading rails

Page	Type	Load capacity kg/Pair	Weight kg/Piece	Length mm	Overall width mm	Height mm	Track width mm
109	87/150SR (w/o ill.)	500	4	1,500	224	47	164
109	87/180SR (w/o ill.)	460	5	1,800	224	47	164
109	87/200SR (w/o ill.)	440	5.5	2,000	224	47	164
109	87/230SR (w/o ill.)	400	6	2,300	224	47	164
109	87/250SR	380	7	2,500	224	47	164
109	87/300SR (w/o ill.)	250	8	3,000	224	47	164
109	87/150SW (w/o ill.)	500	4	1,500	224	47	164
109	87/180SW (w/o ill.)	460	5	1,800	224	47	164
109	87/200SW (w/o ill.)	440	5.5	2,000	224	47	164
109	87/230SW (w/o ill.)	400	6	2,300	224	47	164
109	87/250SW	380	7	2,500	224	47	164
109	87/300SW (w/o ill.)	250	8	3,000	224	47	164

109 | Foldable version available against surcharge, type number plus „K“ (example: 87/300SRK)

Light dock plates

Page	Type	Load capacity kg	Weight kg	Length mm	Overall width mm	max. height- difference mm
110	F 8760	600	17	800	1,000	150
110	F 8762 (w/o ill.)	600	17	1,000	800	170
110	F 8761 (w/o ill.)	1.000	18	800	1,000	150
110	F 8763 (w/o ill.)	1.000	18	1,000	800	170
110	F 8764 (w/o ill.)	1.000	30	1,500	800	280
110	F 8769 (w/o ill.)	1.000	21	1,000	1,000	170
110	F 8770 (w/o ill.)	1.000	26	1,200	1,000	220
110	F 8781 (w/o ill.)	1.500	25	800	1,250	150
110	F 8783 (w/o ill.)	1.500	30	1,000	1,250	170
110	F 8784 (w/o ill.)	1.500	47	1,500	1,250	280
110	F 8790 (w/o ill.)	1.500	39	1,200	1,250	220

Variable dock plates

Page	Type	Load capacity kg	Weight kg	Length mm	Overall width mm	max. height- difference mm
111	F 8771/10	2.000	12	500	1,000	100
111	F 8771/12 (w/o ill.)	2.000	15	500	1,250	100
111	F 8771/15 (w/o ill.)	2.000	19	500	1,500	100
111	F 8771/20 (w/o ill.)	2.000	24	500	2,000	100
111	F 8773/10 (w/o ill.)	2.000	16	700	1,000	100
111	F 8773/15 (w/o ill.)	2.000	25	700	1,500	100
111	F 8773/17 (w/o ill.)	2.000	29	700	1,750	100
111	F 8773/20 (w/o ill.)	2.000	33	700	2,000	100
111	F 8773/15R (w/o ill.)	4.000	36	700	1,500	100
111	F 8773/17R (w/o ill.)	4.000	42	700	1,750	100
111	F 8773/20R (w/o ill.)	4.000	48	700	2,000	100

Light dock boards

Page	Type	Load capacity kg	Weight kg	Length mm	Overall width mm	max. height- difference mm
112	F 8779/1250	4.000	26	550	1,250	±75
112	F 8779/1500 (w/o ill.)	4.000	30	550	1,500	±75
112	F 8779/1750 (w/o ill.)	4.000	36	550	1,750	±75
112	F 8779/2000 (w/o ill.)	4.000	40	550	2,000	±75

Foldable dock-edge levellers

Page	Type	Load capacity kg	Weight kg	Length mm	Overall width mm	Useful width mm	max. height- difference mm
113	F 272013	6.000	240	500/700	2,750	2,000	±130
113	F 2720115 (w/o ill.)	6.000	340	500/700	2,750	2,000	±130
113	F 302213 (w/o ill.)	6.000	250	500/700	3,000	2,250	±130
113	F 3022115 (w/o ill.)	6.000	350	500/700	3,000	2,250	±130

Portable dock plates

Page	Type	Load capacity kg	Weight kg	Length mm	Overall width mm	max. height-difference mm
114	F 2007 (w/o ill.)	4.000	46	2,000	750	±600
114	F 2010	4.000	61	2,000	1,000	±600
114	F 2507 (w/o ill.)	3.400	57	2,500	750	±750
114	F 2510 (w/o ill.)	3.400	75	2,500	1,000	±750
114	F 3007 (w/o ill.)	2.700	68	3,000	750	±900
114	F 3010 (w/o ill.)	2.700	89	3,000	1,000	±900
114	F 3507 (w/o ill.)	2.300	79	3,500	750	±1,050
114	F 3510 (w/o ill.)	2.300	104	3,500	1,000	±1,050
114	F 4007 (w/o ill.)	1.900	90	4,000	750	±1,200
114	F 4010 (w/o ill.)	1.900	118	4,000	1,000	±1,200

Mobile dock boards

Page	Type	Load capacity kg	Weight kg	Length mm	Overall width mm	max. height-difference mm	Bridging distance mm
115	F 720501	4.000	29	520	1,500	±70	190 – 290
115	F 720502 (w/o ill.)	4.000	34	520	1,750	±70	190 – 290
115	F 720503 (w/o ill.)	4.000	39	520	2,000	±70	190 – 290
115	F 721001 (w/o ill.)	4.000	32	590	1,500	±80	260 – 360
115	F 721002 (w/o ill.)	4.000	37	590	1,750	±80	260 – 360
115	F 721003 (w/o ill.)	4.000	43	590	2,000	±80	260 – 360
115	F 721501 (w/o ill.)	4.000	34	690	1,500	±90	360 – 460
115	F 721502 (w/o ill.)	4.000	41	690	1,750	±90	360 – 460
115	F 721503 (w/o ill.)	4.000	47	690	2,000	±90	360 – 460

Vertically portable dock boards

Page	Type	Load capacity kg	Weight kg	Length mm	Overall width mm	max. height-difference mm	Bridging distance mm
116	F 7005	5.000	52	1,300	1,250	0 – 160	–
116	F 7010 (w/o ill.)	5.000	62	1,300	1,500	0 – 160	–
116	F 7025 (w/o ill.)	4.500	61	1,560	1,250	0 – 190	–
116	F 7030 (w/o ill.)	4.500	72	1,560	1,500	0 – 190	–
116	F 7035 (w/o ill.)	4.300	67	1,760	1,250	0 – 220	–
116	F 7040 (w/o ill.)	4.300	79	1,760	1,500	0 – 220	–
116	F 7045 (w/o ill.)	4.000	73	1,960	1,250	0 – 240	–
116	F 7050 (w/o ill.)	4.000	86	1,960	1,500	0 – 240	–

Horizontally portable dock boards

Page	Type	Load capacity kg	Weight kg	Length mm	Overall width mm	max. height-difference mm	Bridging distance mm
117	F 1515 (w/o ill.)	4.500	91	1,500	1,500	0 – 190	–
117	F 1517 (w/o ill.)	4.700	104	1,500	1,750	0 – 190	–
117	F 1520	5.000	117	1,500	2,000	0 – 190	–
117	F 2015 (w/o ill.)	4.000	115	2,000	1,500	0 – 250	–
117	F 2017 (w/o ill.)	4.200	132	2,000	1,750	0 – 250	–
117	F 2020 (w/o ill.)	4.500	149	2,000	2,000	0 – 250	–
117	F 2515 (w/o ill.)	3.500	139	2,500	1,500	0 – 310	–
117	F 2517 (w/o ill.)	3.700	160	2,500	1,750	0 – 310	–
117	F 2520 (w/o ill.)	4.000	181	2,500	2,000	0 – 310	–
117	F 3015 (w/o ill.)	3.000	163	3,000	1,500	0 – 370	–
117	F 3017 (w/o ill.)	3.200	188	3,000	1,750	0 – 370	–
117	F 3020 (w/o ill.)	3.500	213	3,000	2,000	0 – 370	–
117	F 3515 (w/o ill.)	2.500	187	3,500	1,500	0 – 430	–
117	F 3517 (w/o ill.)	2.700	216	3,500	1,750	0 – 430	–
117	F 3520 (w/o ill.)	3.000	245	3,500	2,000	0 – 430	–

Sliding dock-edge levellers

Page	Type	Load capacity kg	Weight kg	Length mm	Overall width mm	max. height-difference mm
118	F 6515	4.000	34	650	1,500	±90
118	F 6517 (w/o ill.)	4.000	40	650	1,750	±90
118	F 6520 (w/o ill.)	4.000	46	650	2,000	±90
118	F 7515 (w/o ill.)	4.000	38	750	1,500	±100
118	F 7517 (w/o ill.)	4.000	45	750	1,750	±100
118	F 7520 (w/o ill.)	4.000	51	750	2,000	±100
118	F 9515 (w/o ill.)	4.000	46	950	1,500	±125
118	F 9517 (w/o ill.)	4.000	54	950	1,750	±125
118	F 9520 (w/o ill.)	4.000	62	950	2,000	±125
119	F 8860/6515 (w/o ill.)	4.000	46	650	1,500	±90
119	F 8860/6517 (w/o ill.)	4.500	52	650	1,750	±90
119	F 8860/6520 (w/o ill.)	5.000	58	650	2,000	±90

Sliding dock-edge levellers

Page	Type	Load capacity kg	Weight kg	Length mm	Overall width mm	max. height-difference mm
119	F 8860/7515 (w/o ill.)	4.000	50	750	1,500	±100
119	F 8860/7517 (w/o ill.)	4.500	57	750	1,750	±100
119	F 8860/7520 (w/o ill.)	5.000	63	750	2,000	±100
119	F 8860/9515 (w/o ill.)	4.000	58	950	1,500	±125
119	F 8860/9517 (w/o ill.)	4.500	66	950	1,750	±125
119	F 8860/9520 (w/o ill.)	5.000	74	950	2,000	±125

Spring-loaded stationary dock levellers

Page	Type	Load capacity kg	Weight kg	Length mm	Overall width mm	max. height-difference mm
120	F 8862/1115 (w/o ill.)	5.000	57	1,150	1,500	±140
120	F 8862/1117 (w/o ill.)	5.000	66	1,150	1,750	±140
120	F 8862/1120 (w/o ill.)	5.000	75	1,150	2,000	±140
120	F 8862/1315 (w/o ill.)	5.000	63	1,300	1,500	±160
120	F 8862/1317 (w/o ill.)	5.000	73	1,300	1,750	±160
120	F 8862/1320 (w/o ill.)	5.000	83	1,300	2,000	±160
120	F 8862/1515	5.000	71	1,500	1,500	±190
120	F 8862/1517 (w/o ill.)	5.000	82	1,500	1,750	±190
120	F 8862/1520 (w/o ill.)	5.000	94	1,500	2,000	±190
120	F 8862/1715 (w/o ill.)	5.000	81	1,750	1,500	±215
120	F 8862/1717 (w/o ill.)	5.000	94	1,750	1,750	±215
120	F 8862/1720 (w/o ill.)	5.000	108	1,750	2,000	±215
120	F 8862/2015 (w/o ill.)	5.000	91	2,000	1,500	±250
120	F 8862/2017 (w/o ill.)	5.000	106	2,000	1,750	±250
120	F 8862/2020 (w/o ill.)	5.000	120	2,000	2,000	±250

Spring-loaded sliding dock levellers

Page	Type	Load capacity kg	Weight kg	Length mm	Overall width mm	max. height-difference mm
121	F 8861/1115	5.000	57	1,150	1,500	±140
121	F 8861/1117	5.000	66	1,150	1,750	±140
121	F 8861/1120	5.000	75	1,150	2,000	±140
121	F 8861/1315	5.000	63	1,300	1,500	±160
121	F 8861/1317	5.000	73	1,300	1,750	±160
121	F 8861/1320	5.000	83	1,300	2,000	±160
121	F 8861/1515	5.000	71	1,500	1,500	±190
121	F 8861/1517	5.000	82	1,500	1,750	±190
121	F 8861/1520	5.000	94	1,500	2,000	±190
121	F 8861/1715	5.000	81	1,750	1,500	±215
121	F 8861/1717	5.000	94	1,750	1,750	±215
121	F 8861/1720	5.000	108	1,750	2,000	±215
121	F 8861/2015	5.000	91	2,000	1,500	±250
121	F 8861/2017	5.000	106	2,000	1,750	±250
121	F 8862/2020	5.000	120	2,000	2,000	±250

Stationary cantilever dock levellers

Page	Type	Load capacity kg	Weight kg	Length mm	Overall width mm	max. height-difference mm
122	8 874	6.000	125	1,500	1,800	±220
122	8 873 (w/o ill.)	4.000	118	1,250	1,800	±170

Optional docking aids & accessories

Page	Type	Description	Special features
123	F 9019010	Bumper	150 mm above ramp height
123	F 9019011	Bumper	250 mm above ramp height
123	F 9019012	Bumper	mounted at ramp height
123	1067	Smooth-running wheel	for type 8 772 20
123	F 9019002	Forklift prong pockets	for type F 720501 - F 721503 and type F 7005 - F 7050
123	F 6038861	Profiled guide rail for dock levellers	for welded mounting
123	F 6016516	Profiled guide rail for sliding dock levellers	for bolted mounting
123	F 6016515	Profiled guide rail for sliding dock levellers	for welded mounting



Order-picking carts & accessories



Stainless steel shelf trolleys

Page	Type	Load capacity/ per shelf kg	Overall dimensions L x W x H mm	Load area L x W mm	Push- handles	Shelves	Shelf spacing mm	Weight kg	Wheel Ø mm
128	90 5001 12	120/80	870 x 570 x 950	800 x 500	2	2	265/850	15	125
128	90 5011 12 (w/o ill.)	120/80	1,070 x 570 x 950	1,000 x 500	2	2	265/850	16	125
128	90 5017 12 (w/o ill.)	120/80	1,070 x 670 x 950	1,000 x 600	2	2	265/850	17	125
128	90 5005 12	150/80	870 x 570 x 950	800 x 500	2	3	300/575/850	17	125
128	90 5013 12 (w/o ill.)	150/80	1,070 x 570 x 950	1,000 x 500	2	3	300/575/850	19	125
128	90 5019 12 (w/o ill.)	150/80	1,070 x 670 x 950	1,000 x 600	2	3	300/575/850	22	125

Aluminium four-wheel carts

Page	Type	Load capacity kg	Overall dimensions L x W x H mm	Load area L x W mm	Push- handles	Sides	Weight kg	Wheel Ø mm
129	910 631 76	500	1,060 x 730 x 1,000	955 x 700	1	1	36	200
129	910 641 76 (w/o ill.)	500	1,310 x 830 x 1,000	1,205 x 800	1	1	38	200
129	910 632 76	500	1,120 x 730 x 1,000	910 x 700	2	2	39	200
129	910 642 76 (w/o ill.)	500	1,370 x 830 x 1,000	1,160 x 800	2	2	41	200
129	910 633 76	500	1,120 x 730 x 1,000	910 x 655	2	3	44	200
129	910 643 76 (w/o ill.)	500	1,370 x 830 x 1,000	1,160 x 755	2	3	46	200
129	910 634 76	500	1,120 x 730 x 1,000	910 x 610	2	4	49	200
129	910 644 76 (w/o ill.)	500	1,370 x 830 x 1,000	1,160 x 710	2	4	51	200
129	910 635 76 (w/o ill.)	500	1,120 x 730 x 1,000	955 x 700	1	—	33	200
129	910 645 76 (w/o ill.)	500	1,370 x 830 x 1,000	1,205 x 800	1	—	38	200
129	910 639 76 (w/o ill.)	500	1,120 x 730 x 1,000	910 x 700	2	—	35	200
129	910 649 76 (w/o ill.)	500	1,370 x 830 x 1,000	1,160 x 800	2	—	40	200

Carts with folding handle

Page	Type	Load capacity kg	Overall dimensions L x W x H mm	Load area L x W mm	Push- handles	Weight kg	Wheel Ø mm
130	90 505 11	150	815 x 460 x 930	720 x 450	1	16	125
130	90 515 16 (w/o ill.)	250	1,030 x 605 x 965	900 x 600	1	25	160
130	90 516 11	150	815 x 460 x 930	720 x 450	1	11	125
130	90 517 16 (w/o ill.)	150	1,030 x 605 x 965	900 x 600	1	18	160

Warehouse & platform carts

Page	Type	Load capacity kg	Overall dimensions L x W x H mm	Load area L x W mm	Push- handles	Sides	Weight kg	Wheel Ø mm
131	90 525 16	400	970 x 500 x 950	850 x 500	1	—	24	160
131	90 2501 20 (w/o ill.)	500	1,120 x 600 x 990	1,000 x 600	1	—	30	200
131	90 535 20 (w/o ill.)	500	1,120 x 700 x 990	1,000 x 700	1	—	33	200
131	90 545 20 (w/o ill.)	500	1,320 x 800 x 990	1,200 x 800	1	—	38	200
131	90 528 16	400	970 x 500 x 950	850 x 500	1	4	30	160
131	90 538 21 (w/o ill.)	500	1,120 x 600 x 990	1,000 x 600	1	4	36	160
131	90 538 20 (w/o ill.)	500	1,120 x 700 x 990	1,000 x 700	1	4	40	200
131	90 548 20 (w/o ill.)	500	1,320 x 800 x 990	1,200 x 800	1	4	46	200
132	90 521 16	400	970 x 500 x 950	850 x 500	1	1	26	160
132	90 561 20 (w/o ill.)	500	1,120 x 600 x 990	1,000 x 600	1	1	33	200
132	90 531 20 (w/o ill.)	500	1,120 x 700 x 990	1,000 x 700	1	1	36	200
132	90 541 20 (w/o ill.)	500	1,320 x 800 x 990	1,200 x 800	1	1	42	200
132	90 522 16	400	1,030 x 500 x 950	850 x 500	2	2	30	160
132	90 562 20 (w/o ill.)	500	1,180 x 600 x 990	1,000 x 600	2	2	38	200
132	90 532 20 (w/o ill.)	500	1,180 x 700 x 990	1,000 x 700	2	2	42	200
132	90 542 20 (w/o ill.)	500	1,380 x 800 x 990	1,200 x 800	2	2	48	200
132	90 523 16	400	1,030 x 500 x 950	850 x 500	2	3	34	160
132	90 563 20 (w/o ill.)	500	1,180 x 600 x 990	1,000 x 600	2	3	42	200
132	90 533 20 (w/o ill.)	500	1,180 x 700 x 990	1,000 x 700	2	3	46	200
132	90 543 20 (w/o ill.)	500	1,380 x 800 x 990	1,200 x 800	2	3	54	200
132	90 524 16	400	1,030 x 500 x 950	850 x 500	2	4	38	160
132	90 2551 20 (w/o ill.)	500	1,180 x 600 x 990	1,000 x 600	2	4	47	200
132	90 534 20 (w/o ill.)	500	1,180 x 700 x 990	1,000 x 700	2	4	51	200
132	90 544 20 (w/o ill.)	500	1,380 x 800 x 990	1,200 x 800	2	4	59	200

Table trolleys

Page	Type	Load capacity/ per shelf kg	Overall dimensions L x W x H mm	Load area L x W mm	Push- handles	Shelves	Shelf height mm	Weight kg	Wheel Ø mm
133	90 2400 16	400/200	1,047 x 509 x 865	850 x 500	1	2	235/865	38	160
133	90 2401 20 (w/o ill.)	500/200	1,197 x 609 x 905	1,000 x 600	1	2	275/905	47	200
133	90 732 20 (w/o ill.)	500/200	1,197 x 709 x 905	1,000 x 700	1	2	275/905	52	200
133	90 742 20 (w/o ill.)	500/200	1,397 x 809 x 905	1,200 x 800	1	2	275/905	61	200
133	90 2420 16	400/200	1,047 x 509 x 865	850 x 500	1	3	235/550/865	51	160
133	90 733 20 (w/o ill.)	500/200	1,197 x 709 x 905	1,000 x 700	1	3	275/590/905	70	200
133	90 743 20 (w/o ill.)	500/200	1,397 x 809 x 905	1,200 x 800	1	3	275/590/905	82	200

Shelf trolleys

Page	Type	Load capacity/ per shelf kg	Overall dimensions L x W x H mm	Load area L x W mm	Push- handles	Shelves	Shelf spacing mm	Weight kg	Wheel Ø mm
134	90 123 16 (w/o ill.)	400/90	1,020 x 509 x 1,055	850 x 500	1	3	225/585/945	42	160
134	90 163 16	500/90	1,070 x 609 x 1,100	1,000 x 600	1	3	270/630/990	53	200
134	90 8102 20 (w/o ill.)	500/90	1,070 x 709 x 1,100	1,000 x 700	1	3	270/630/990	58	200
134	90 8103 20 (w/o ill.)	500/90	1,370 x 809 x 1,800	1,200 x 800	1	3	270/630/990	71	200
134	90 8321 20	500/120	1,170 x 609 x 1,800	1,000 x 600	1	4	270/700/1,100/1,500	74	200
134	90 8322 20 (w/o ill.)	500/120	1,170 x 709 x 1,800	1,000 x 700	1	4	270/700/1,100/1,500	82	200
134	90 8323 20 (w/o ill.)	500/120	1,370 x 809 x 1,800	1,200 x 800	1	4	270/700/1,100/1,500	101	200
135	90 8110 16	400/90	1,020 x 509 x 1,055	850 x 500	1	3	225/585/945	46	160
135	90 8111 20 (w/o ill.)	500/90	1,070 x 609 x 1,100	1,000 x 600	1	3	270/630/990	60	200
135	90 8112 20 (w/o ill.)	500/90	1,070 x 709 x 1,100	1,000 x 700	1	3	270/630/990	65	200
135	90 8113 20 (w/o ill.)	500/90	1,370 x 809 x 1,100	1,200 x 800	1	3	270/630/990	78	200
135	90 8130 16	400/120	1,020 x 509 x 1,055	850 x 500	1	3	225/585/945	52	160
135	90 8131 20 (w/o ill.)	500/120	1,070 x 609 x 1,100	1,000 x 600	1	3	270/630/990	69	200
135	90 8132 20 (w/o ill.)	500/120	1,070 x 709 x 1,100	1,000 x 700	1	3	270/630/990	75	200
135	90 8133 20 (w/o ill.)	500/120	1,370 x 809 x 1,100	1,200 x 800	1	3	270/630/990	90	200

Transport carts

Page	Type	Load capacity kg	Overall dimensions L x W x H mm	Load area L x W mm	Push- handles	Shelves	Shelf spacing mm	Weight kg	Wheel Ø mm
136	90 1580 16	400	910 x 500 x 985	850 x 500	4	—	—	29	160
136	90 1581 20 (w/o ill.)	500	1,060 x 600 x 1,025	1,000 x 600	4	—	—	35	200
136	90 1582 20 (w/o ill.)	500	1,060 x 700 x 1,025	1,000 x 700	4	—	—	40	200
136	90 1583 20 (w/o ill.)	500	1,260 x 800 x 1,025	1,200 x 800	4	—	—	44	200
136	90 966 16	400	900 x 650 x 960	850 x 500	1	—	—	26	160
136	90 296 10 (w/o ill.)	500	1,130 x 750 x 1,000	1,000 x 600	1	—	—	31	200
136	90 967 20 (w/o ill.)	500	1,130 x 850 x 1,000	1,000 x 700	1	—	—	34	200
137	90 4595 20	400	1,430 x 620 x 1,800	1,250 x 610	1	2	variable, 120 mm	66	200
137	90 4596 20 (w/o ill.)	400	1,600 x 620 x 1,800	1,420 x 610	1	2	variable, 120 mm	73	200
137	90 2722 12	250/100	1,060 x 600 x 990	1,000 x 600	1	2	195/890	52	125

Scissor-lift platform truck & furniture dolly

Page	Type	Load capacity kg	Overall dimensions L x W x H mm	Load area L x W mm	Push- handles	Lifting range mm	Weight kg	Wheel Ø mm
138	90 6833 10	500	1,185 x 520 x 1,155	1,010 x 520	1	435 - 1,000	118	150
138	90 6834 15 (w/o ill.)	750	1,260 x 520 x 1,155	1,010 x 520	1	442 - 1,000	120	150
138	90 6835 15 (w/o ill.)	1,000	1,260 x 520 x 1,155	1,010 x 520	1	445 - 950	137	150
138	90 6980 15	600	600 x 390 x 800	300 x 110	—	300	45	150

Multi-purpose & pallet jacks

Page	Type	Load capacity kg	Overall dimensions L x H mm	Fork length mm	Overall width mm	Weight kg	max. lifting height mm
139	0 673 01	750	1,100 x 1,050	825	560 - 980	38	130/180
139	0 673 02 (w/o ill.)	750	1,300 x 1,050	1,025	560 - 980	40	130/180
139	0 673 03 (w/o ill.)	1,000	1,100 x 1,050	825	560 - 980	42	130/180
139	0 673 04 (w/o ill.)	1,000	1,300 x 1,050	1,025	560 - 980	44	130/180
139	0 674	2,500	1,535 x 1,225	1,150	520	60	200

Accessories for order-picking carts

Page	Type	Short description	Wheel Ø mm
140	90 79-98/-99/-00	Wheel set with pneum. tyres	125/160/200
140	90 12 86/90 79 87	Wheel set with Elastik tyres	160/200
140	90 79-95/-96/-86	Wheel set of polyamide wheels	125/160/200
140	90 79 81	Bumper rollers of light-grey plastic	50
140	90 21-85/-86/90 79 73	Set of wheels with blue-grey solid rubber tyres	125/160/200
140	90 79-75/-76/-77	Set of wheels with electrically conducting solid rubber tyres	125/160/200
140	Wheel no. 42	Wheel no. 42 with treadless Airelastik tyre	200
140	Wheel no. 76	Wheel no. 76 with smooth-running treadless tyre	200
141	90 79 88	Four swivel castors	—
141	90 79 89	Bumper strip	—
141	90 00 90	Wire basket	—
141	90 11-47/-48	Notepad support for DIN A 4 portrait/landscape	—
141	90 68 90	Roller table with mounting frame (rigid), load capacity 500 kg	—
141	90 68 91	Roller table with turntable (rotatable), load capacity 500 kg	—

EXPERIENCE

